



PETTENGELLS
ESTATE AGENTS

5 Brooklyn Court, New Milton, Hampshire, BH25 5PA
Asking Price £325,000

5 Brooklyn Court, New Milton, Hampshire, BH25 5PA

- Impressive low maintenance bungalow
- Two bedrooms
- Living/dining room
- Refurbished kitchen
- Shower/wet room
- Gardens
- Garage
- Close to town
- Chain free sale





IMPRESSIVE LOW MAINTENANCE BUNGALOW, CONVENIENTLY SITUATED CLOSE TO TOWN AND OFFERED AS A 'CHAIN FREE' SALE.

Accommodation: There is an entrance porch and then living/dining room, this leads into the refurbished kitchen which overlooks the rear garden. There are two bedrooms and a shower/wet room.

Outside: There is the front and rear garden and a garage in a block.

EPC: D, Council tax band: C, Tenure: Freehold, Approx floor area: 560 sq ft

PETTENGELLS
ESTATE AGENTS

21 Old Milton Road, Hampshire, BH25 6DQ | 01425 629100 | newmilton@pettengells.co.uk | www.pettengells.co.uk

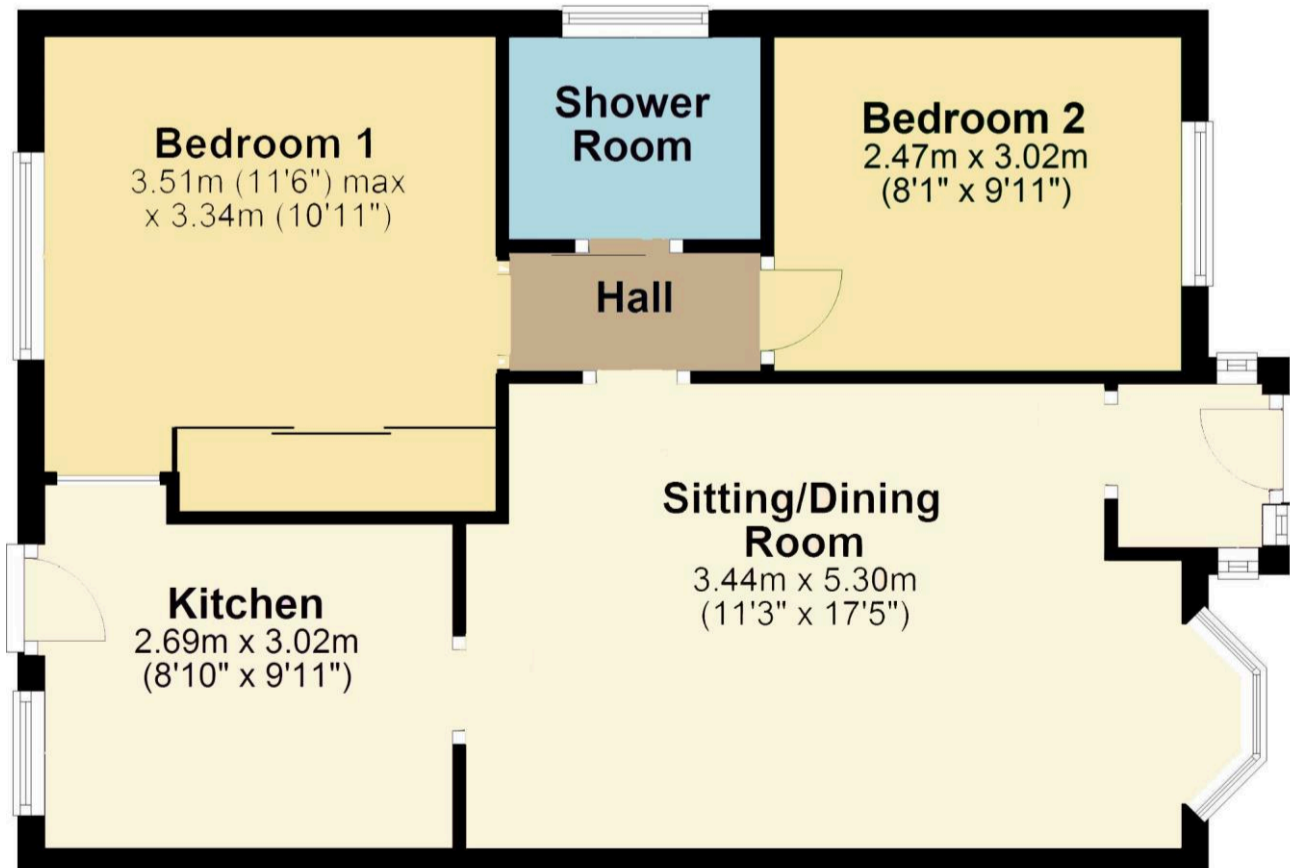

VERY IMPORTANT, PLEASE READ: There may be omissions in these sales particulars and they do not constitute part of a contract. Floor plans are for representational purposes only and may not be to scale. All measurements including floor area (which may or may not include garage and/or conservatory) are approximate and should not be relied upon. We make no assertion that the property is in good condition or otherwise, nor that any services, appliances or systems are in good working order. Items depicted in photos may not be included. Maintenance/ground rent figures have been supplied by the seller. Maintenance tends to go up every year and there can be extra charges. Ground rent tends to increase periodically. We will endeavour to mention if a property is not of standard construction but we are not always able to establish this. We are not aware of issues affecting the structural integrity of the property or whether there is any asbestos present (including outbuildings). Most properties have restrictive covenants. Please ask us if you would like sight of these prior to offering. Alternatively your solicitor will advise on these during conveyancing. There is general coastal erosion on the Barton coastline. We are not aware of any current planning permissions close to the property that may cause concern but this could be looked into. Potential viewers and purchasers should investigate and/or verify all relevant points and if appropriate, commission experts including surveyor to report before proceeding, and we will assist whenever possible.

PETTENGELLS
ESTATE AGENTS

21 Old Milton Road, Hampshire, BH25 6DQ | 01425 629100 | newmilton@pettengells.co.uk | www.pettengells.co.uk