



**PETTENGELLS**  
ESTATE AGENTS

10 Seafield Road, Barton On Sea, Hampshire, BH25 7JS  
**Asking Price £775,000**

10 Seafield Road, Barton On Sea, Hampshire,  
BH25 7JS

- Magnificent single story residence
- Fabulous south westerly garden
- Lots of parking and large garage
- Well appointed kitchen
- 3/4 bedrooms
- Bedroom 4/second reception room
- Bathroom and ensuite
- Living room overlooking garden
- Call for a viewing
- Walking distance to cliff top







Outside: This delightful property sits on a generous plot size, which is both wide and long, giving lovely lawned gardens to the front and rear, as well as a very wide driveway, as well as space to turn. This leads via gates to the detached single garage which has electric door. The large rear garden is a lovely feature with ideal south westerly aspect. There is an extensive paved patio adjoining the bungalow.

EPC B, Council tax band: D but subject to change

21 Old Milton Road, Hampshire, BH25 6DQ | 01425 629100 | [newmilton@pettengells.co.uk](mailto:newmilton@pettengells.co.uk) | [www.pettengells.co.uk](http://www.pettengells.co.uk)

**PETTENGELLS**  
ESTATE AGENTS

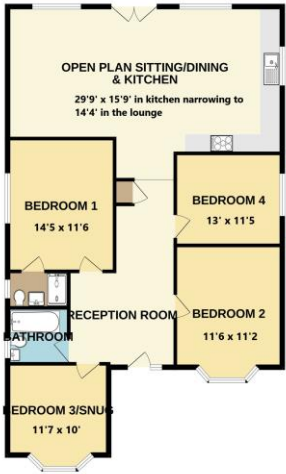

**TOTAL FLOOR AREA: 1471 sq.ft. (136.7 sq.m.) approx.**

Whilst every attempt has been made to ensure the accuracy of the floorplan contained here, measurements of doors, windows, rooms and any other items are approximate and no responsibility is taken for any error, omission or mis-statement. This plan is for illustrative purposes only and should be used as such by any prospective purchaser. The services, systems and appliances shown have not been tested and no guarantee is given as to their operability or efficiency can be given.

Made with Metropix ©2025



**PETTENGELLS**  
ESTATE AGENTS

21 Old Milton Road, Hampshire, BH25 6DQ | 01425 629100 | [newmilton@pettengells.co.uk](mailto:newmilton@pettengells.co.uk) | [www.pettengells.co.uk](http://www.pettengells.co.uk)